

RECOMMENDED P.C.B. LAYOUT

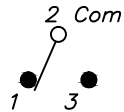

CIRCUIT: SPDT  
CONTACT CONFIGURATION

SWITCH FUNCTION		
PDS. 1	PDS. 2	PDS. 3
DN	NONE	<DN>
2-3	NONE	2-1

( ) = Momentary

NOTES:

1. ALL DIMENSIONS IN MM
2. GENERAL TOLERANCE: X.X=±0.4  
X.XX=±0.25
3. TERM. NOS. FOR REF. ONLY
4. CONTACT RATING: 3A @ 120 VAC or 28 VDC, 1A @ 250 VAC
- ▲ 5. CONTACTS: SILVER
6. ELECTRIC LIFE: 30,000 make-and-break cycles at full load.
7. INSULATION RESISTANCE: 1,000 M ohm min.
8. DIELECTRIC STRENGTH: 1,000 V RMS @sea level.
9. OPERATING TEMP.: -30°C to 85°C
10. HARDWARE TO BE SHIPPED BULK  
T200000-LOCK WASHER-QTY-1  
T200002-LOCK RING-QTY-1  
T200001-HEX NUT-QTY-2

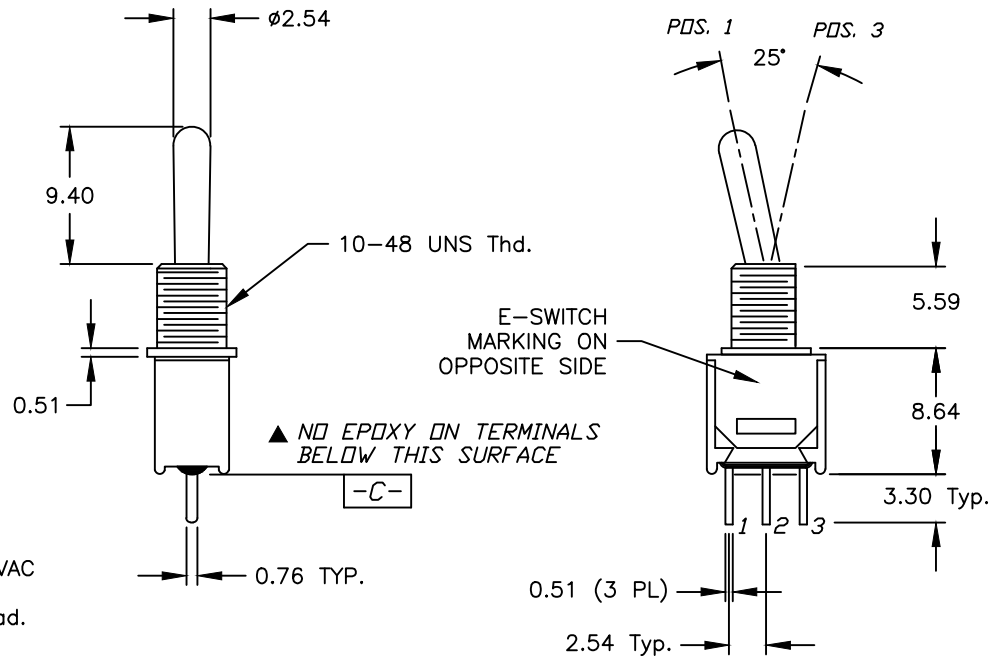
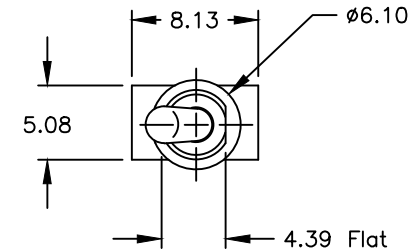

A	21942	INITIAL RELEASE	8/5/15	MW
REV.	ECN No.	DESCRIPTION	DATE	CHKD

THE INFORMATION CONTAINED IN THIS DOCUMENT IS PROPRIETARY TO E-SWITCH AND IS NOT TO BE COPIED OR TRANSFERRED

TITLE				
200MSP2T1B1M2QEH				
SCALE	DATE	DR	DWG	REV
2:1	8/4/2015	MW	ST213005	A